

Regrazer – Specification

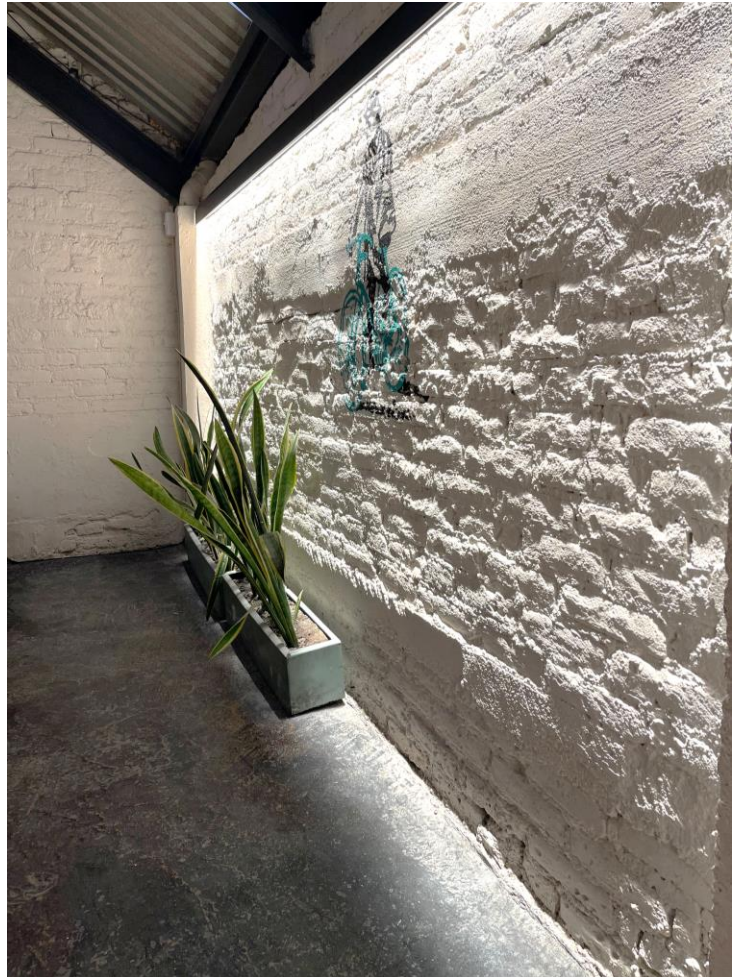

The Regrazer is a small cove grazer that **grazes surfaces up to 40' height**. The inner geometry along with using latest CSP chip technology and glare-reducing optics make this fixture outstanding in both performance and glare protection. Can be mounted directly to ceilings or by using the bracket accessory for wall mounting. Fixture can be cut on site.

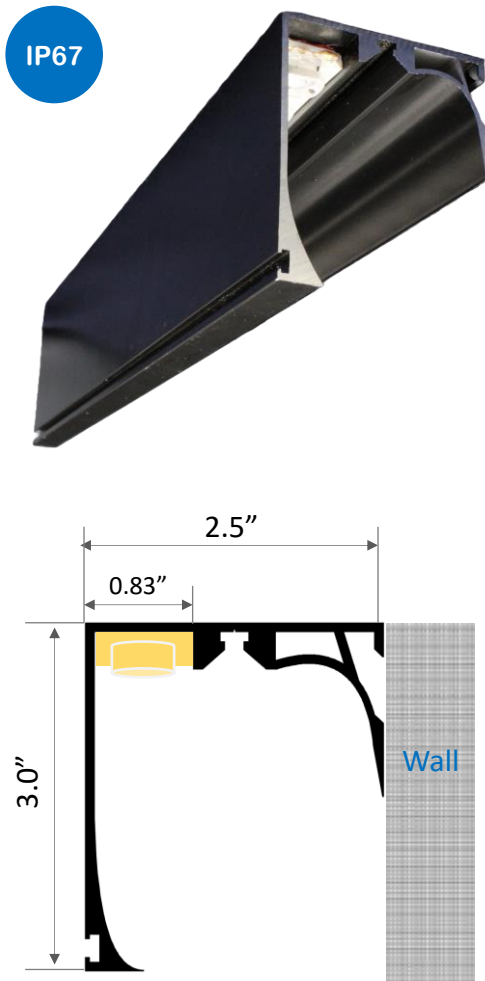

Product Detail:

Material:	Extruded Aluminum
Colors:	Black, Silver
Dimension (in):	L 78.74" x W 2.5" x H 3.0"
Customization:	Cut to specified length

Applications:

- Regressed
- Office
- Hallways
- Outdoors
- Lobbies
- Grazing

Regrazer – Technical Data



Technical Information

Model	CCT	Output (lm/ft)	LEDs/ft	Consump. (watt/ft)	Efficacy (lm/watt)	CRI	Voltage	Max run length	Cut increment
RG-D10	2700K	~520	14	6.0 W	~90	>90	24V	32'	6"
	3000K	~540	14	6.0 W	~90	>90	24V	32'	6"
	3500K	~570	14	6.0 W	~95	>90	24V	32'	6"
	4000K	~575	14	6.0 W	~95	>90	24V	32'	6"

Ordering Code

Example: RG-D1027-CB-BR-DTR-16'-W-RC

Regrazer, 2700K, Black, Bracket, Non-Dimming, 16 ft, Wall Grazing, Regressed Ceiling

RG-D10	-	27	-	CB	-	BR	-	NTR	-	16'	-	W-RC
--------	---	----	---	----	---	----	---	-----	---	-----	---	------

Model	+	CCT	+	Finished	+	Accessories	+	Driver	+	Length	+	Installation
-------	---	-----	---	----------	---	-------------	---	--------	---	--------	---	--------------

RG-D10		27 2700K		CB Black		BR Bracket		NTR Non-Dimming		Enter length:		Wall Grazing
		30 3000K		CS Silver		MIF Mud-In-Flange		DTR 10%-0-10V		6" increment,		W-SM Surface Mount
		35 3500K						DUR 1%-0-10V		Max 32 ft		W-RC Regressed Ceiling
		40 4000K				LC Linear Connector		FPD 0.1%-0-10V				W-RD Regressed Drywall
												W-WM Wall Mount
												W-WMD Wall Mount Drywall
												W-IU Inground Up
												Ceiling Grazing
												C-WM Wall Mount
												Ground Grazing
												G-GO Ground Out

Power Supply Ordering Codes

DTR		+	60		+	IP67		DTR60IP67 - Dimming, 60 Watt, IP67													
MODEL		+	POWER		+	IP RATING		INPUT	OUTPUT	DIMENSION											
NTR Non-Dimming		+	50	50 Watt	+	IP00	Indoor	88-264V	24V	3.90 x 3.82 x 1.42											
				75 Watt						5.08 x 3.82 x 1.50											
				100 Watt						6.26 x 3.82 x 1.50											
				150 Watt						7.84 x 3.85 x 1.50											
				200 Watt						8.46 x 4.53 x 1.18											
				320 Watt						8.46 x 4.53 x 1.18											
				750 Watt						9.84 x 5.00 x 1.61											
				960 Watt						11.60 x 5.00 x 1.61											
											+	12	12 Watt	+	IP42	Indoor	90-264V	24V	3.03 x 1.57 x 1.14		
													16 Watt						3.03 x 1.57 x 1.14		
													25 Watt						3.31 x 2.24 x 1.16		
													35 Watt						3.31 x 2.24 x 1.16		
		+	20	20 Watt	+	IP67	Outdoor	90-264V	24V	4.65 x 1.38 x 1.02											
				35 Watt						5.83 x 1.57 x 1.18											
				60 Watt						6.40 x 1.67 x 1.26											
				100 Watt						7.48 x 2.05 x 1.46											
				150 Watt						7.52 x 2.48 x 1.48											
				240 Watt						9.61 x 2.68 x 1.53											
320 Watt	9.92 x 3.54 x 1.72																				
DTR Dimming min 10% (0-10V)		+	16	16 Watt	+	IP30	Indoor	90-305V	24V	5.83 x 1.57 x 1.26											
				25 Watt						6.40 x 1.70 x 1.26											
				40 Watt						6.40 x 1.70 x 1.26											
				60 Watt						6.34 x 2.40 x 1.42											
				90 Watt						8.66 x 2.68 x 1.53											
				96 Watt						8.66 x 2.68 x 1.53											
				120 Watt						8.97 x 2.68 x 1.58											
				150 Watt						8.97 x 2.68 x 1.58											
				185 Watt						9.88 x 2.68 x 1.58											
				240 Watt						9.92 x 3.54 x 1.72											
		+	480	480 Watt	+	IP67	Outdoor	90-305V	24V	10.32 x 4.92 x 1.72											
				600 Watt						11.02 x 5.67 x 1.91											
											+	20	20 Watt	+	IP67	Outdoor	120V	24V	4.92 x 2.20 x 0.79		
													40 Watt						4.92 x 2.20 x 0.79		
													60 Watt						4.92 x 2.20 x 0.79		
													75 Watt						4.92 x 2.20 x 0.79		
96 Watt	4.92 x 2.20 x 0.79																				
FPD Dimming min 1% (Forward Phase)		+	20	20 Watt	+	IP14	Outdoor	120V	24V	5.60 x 2.00 x 2.14											
				40 Watt						5.60 x 2.00 x 2.14											
				60 Watt						6.62 x 2.58 x 2.33											
				96 Watt						6.62 x 2.58 x 2.33											
				150 Watt						9.80 x 3.00 x 2.74											
				200 Watt						9.80 x 3.00 x 2.74											
300 Watt	10.07 x 4.20 x 3.50																				

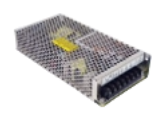

Bracket

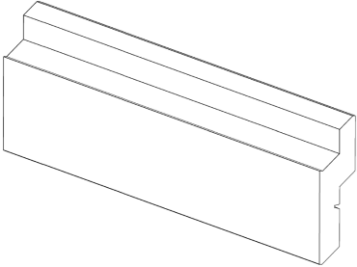
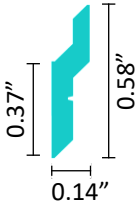
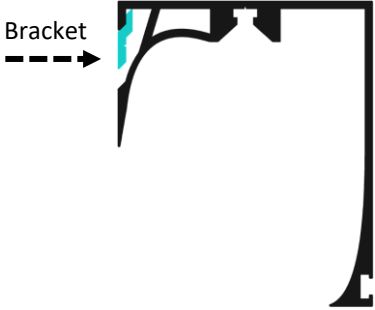
 <p>RG02-BR Bracket</p>		
---	---	--

Mud-In Flange

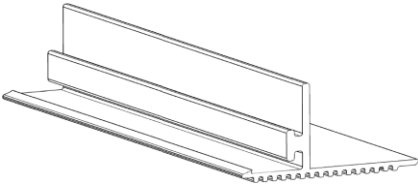
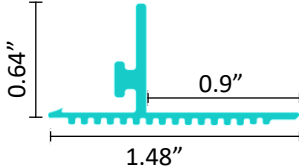
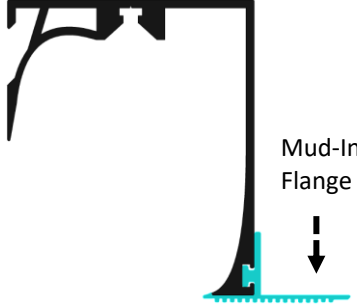
 <p>RG02-MI Mud-In Flange</p>		
--	---	---

End Cap

 <p>RG02-EC End Cap</p>	
---	---

Linear Connector

 <p>RG02-LC Connector</p>

Installation: (W-SM) Wall Grazing / Surface Mount

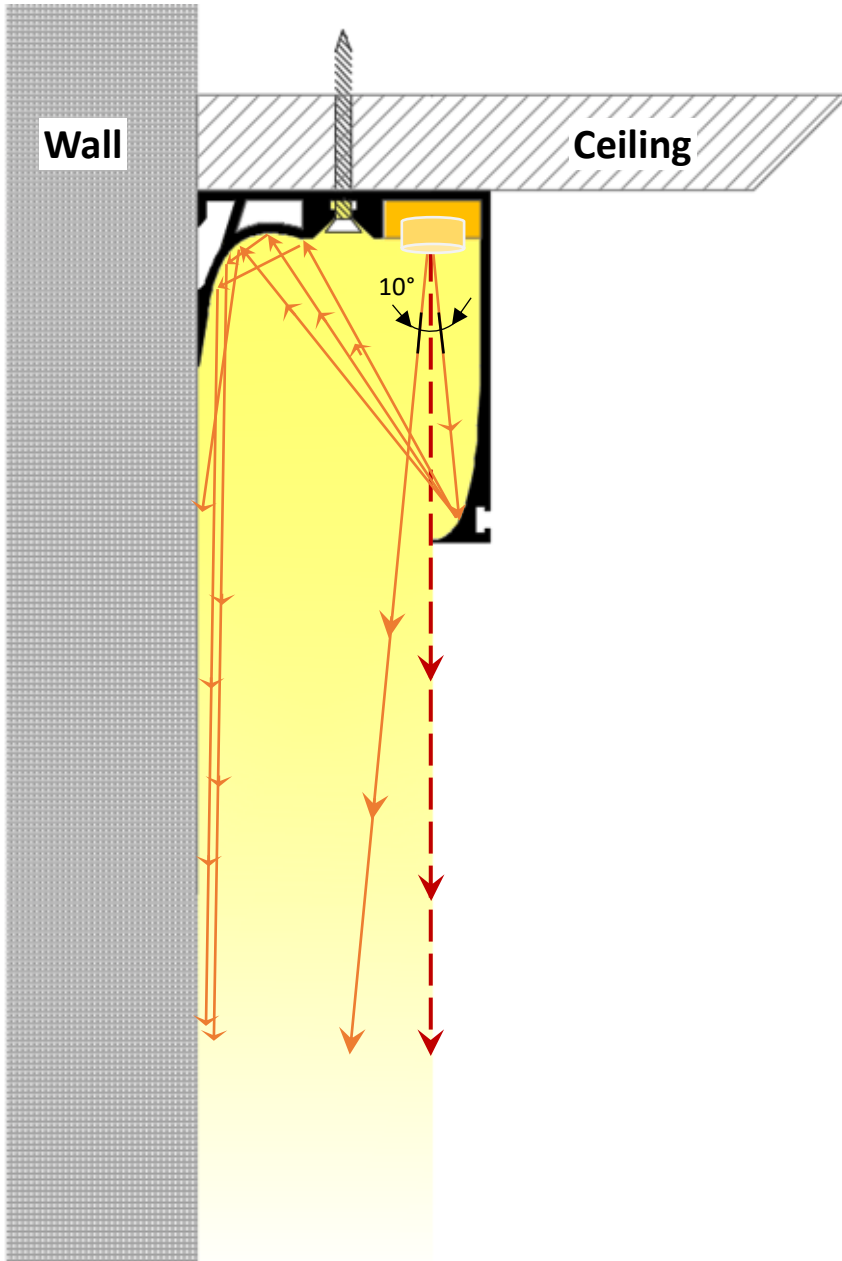

Installation: (W-RC) Wall Grazing / Regressed (Ceiling) with blocking

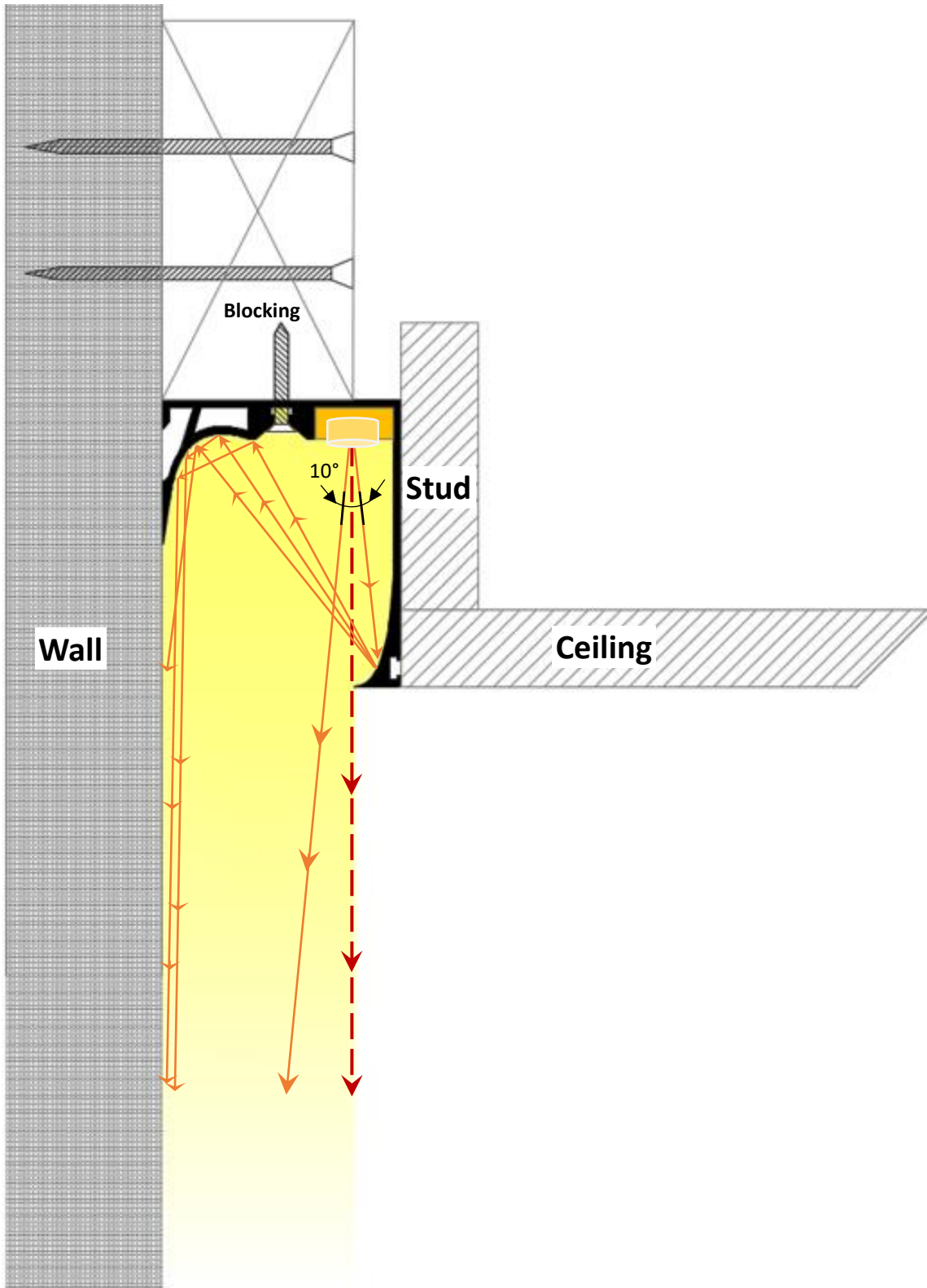

Installation: (W-RD) Wall Grazing / Regressed (Drywall) w/ blocking + mud-in flange

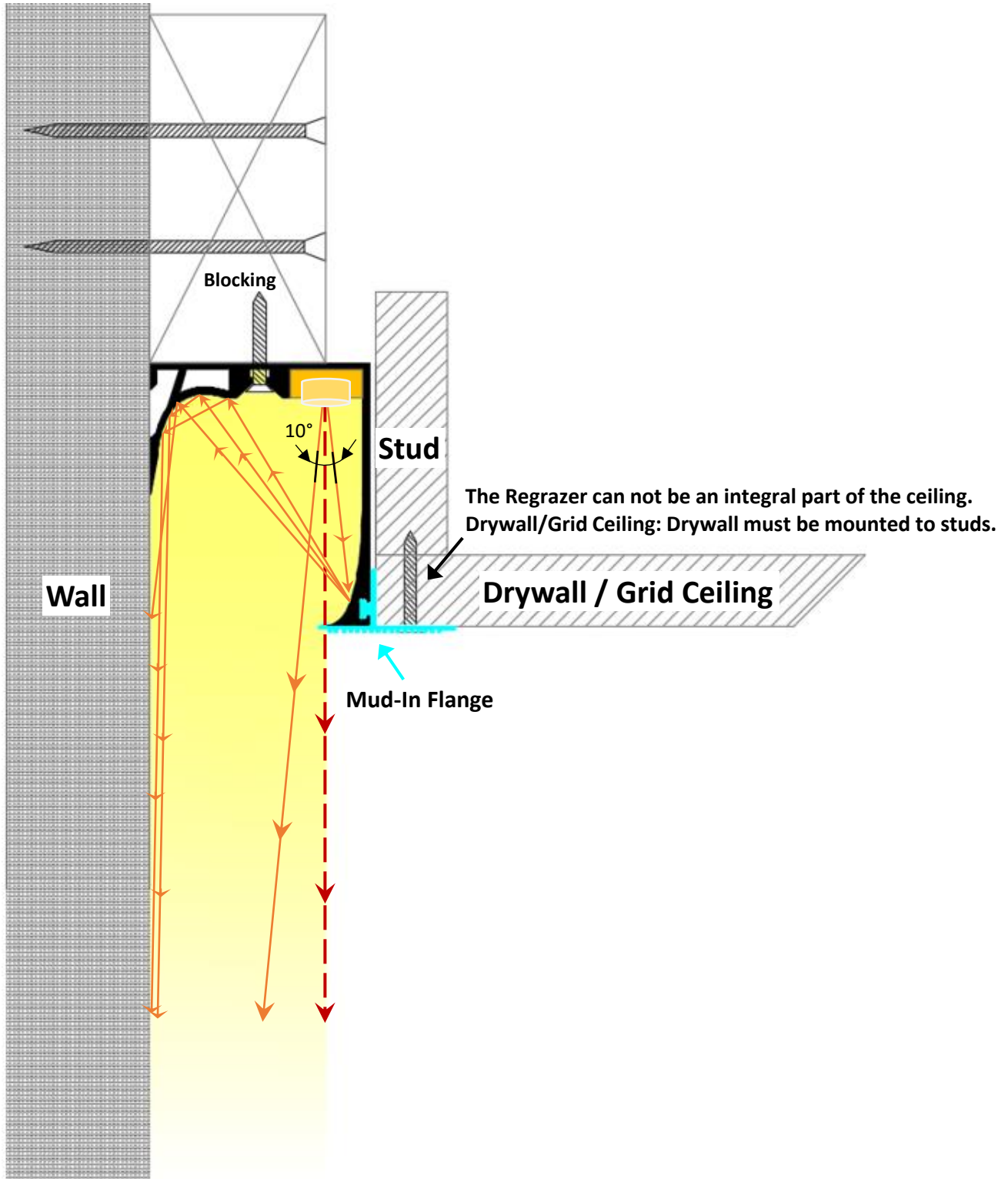

Installation: (W-WM) Wall Grazing / Wall Mount (regressed with bracket)

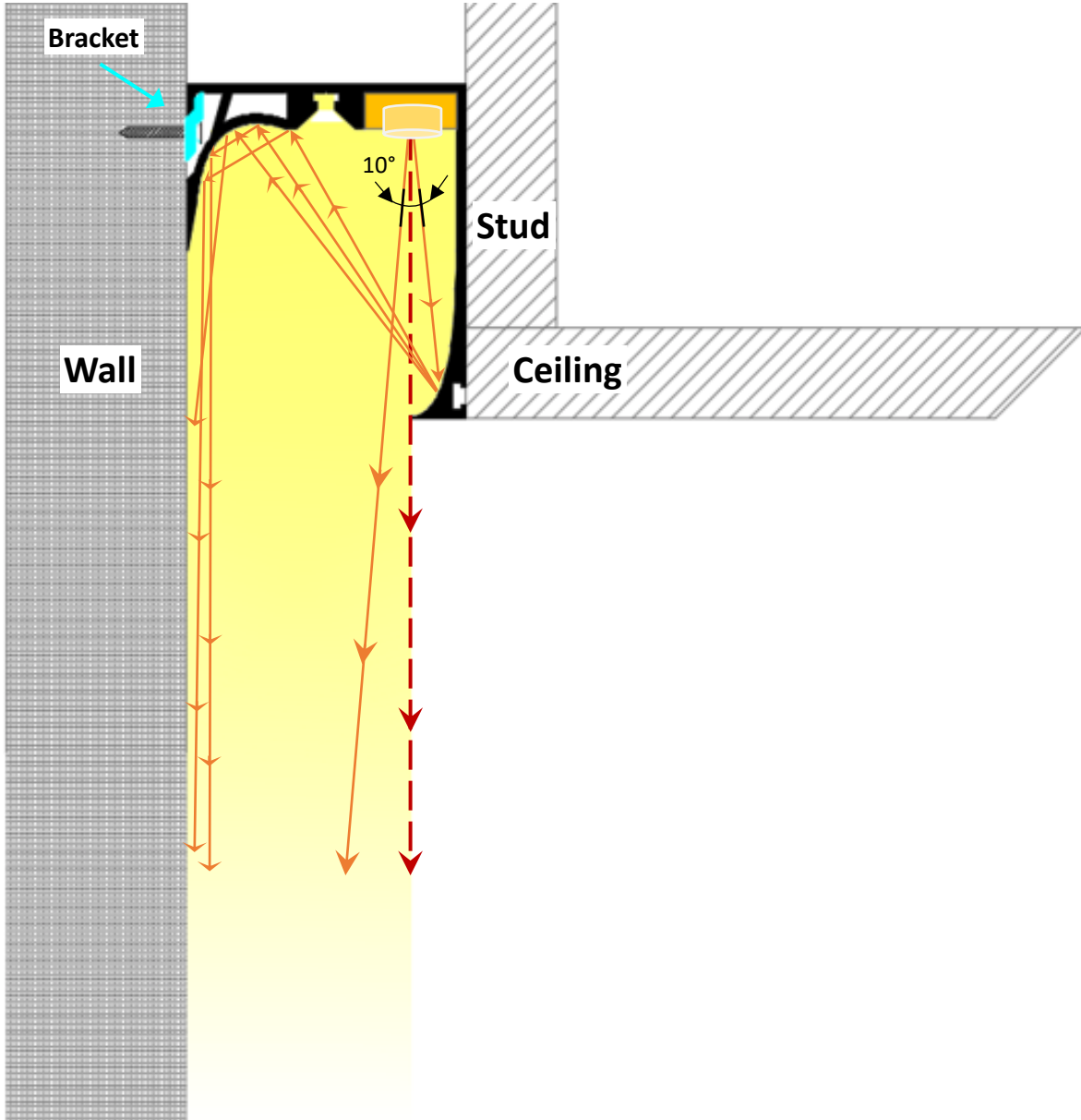

Regrazer – Wall Mount Installation

Installation: (W-WMD) Wall Grazing / Wall Mount (Drywall)
(regressed with bracket + mud-in flange)

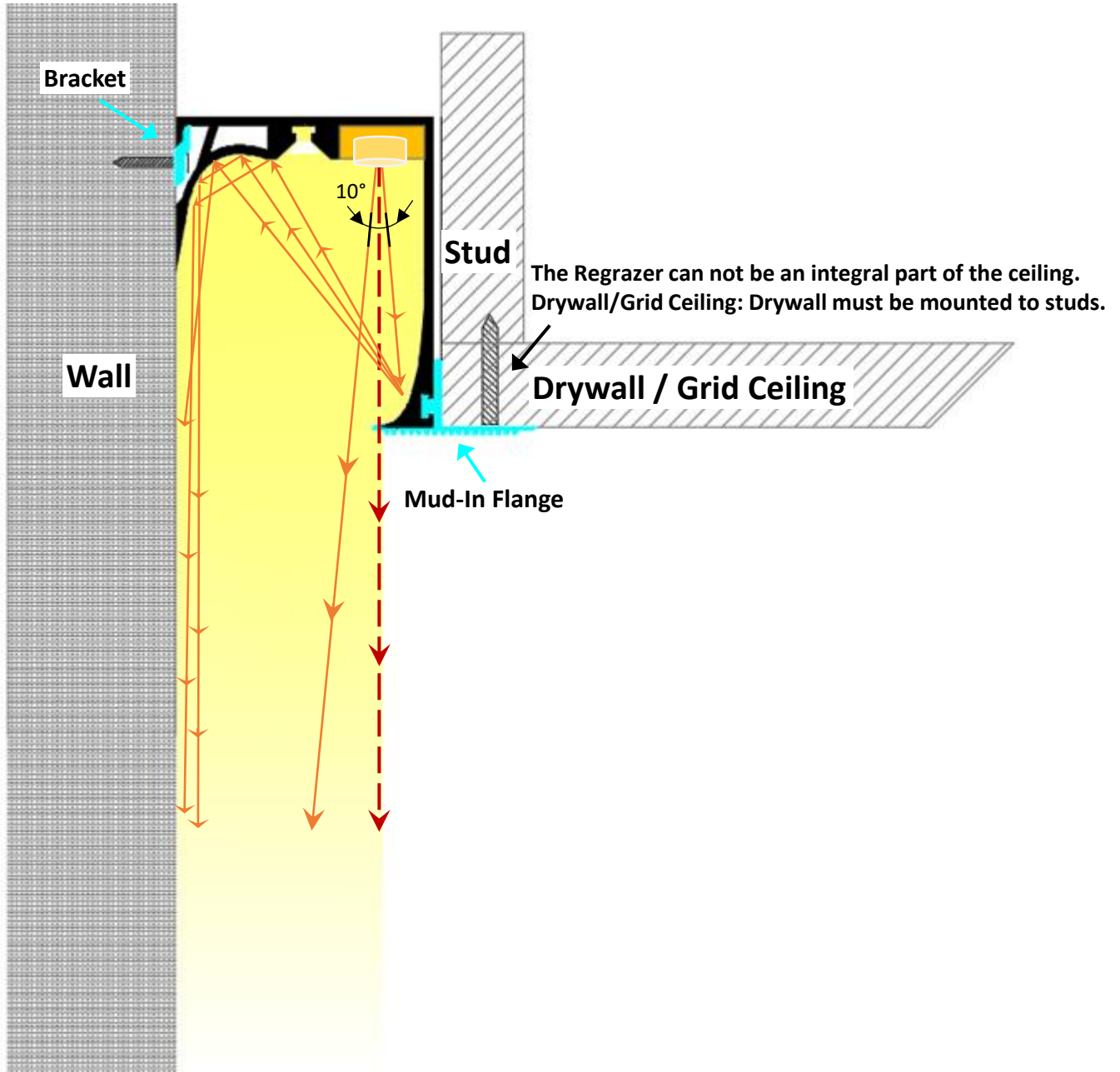

Installation: (W-IU) Wall Grazing / Inground Up (Indoor Only)

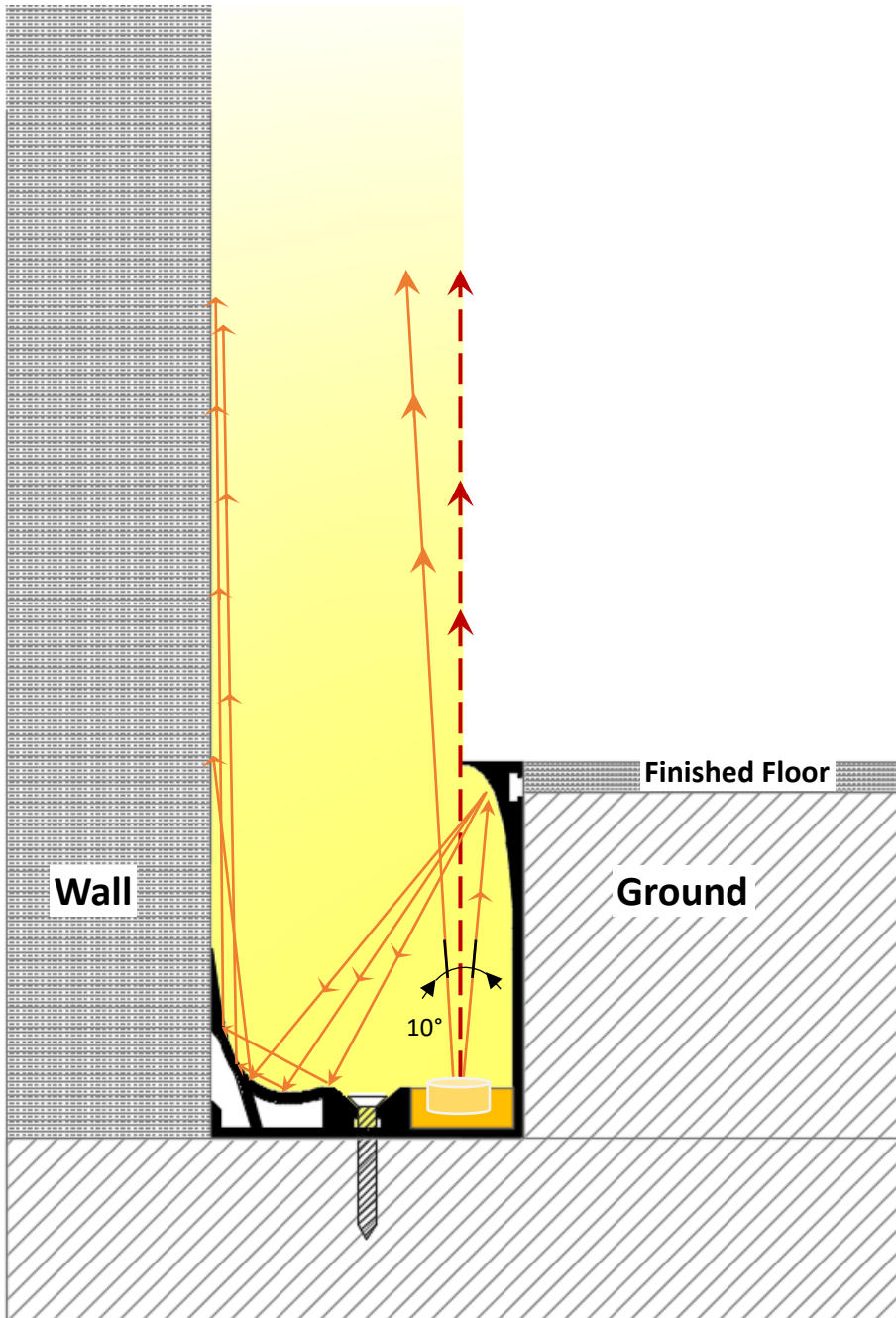

Installation: (C-WM) Ceiling Grazing / Wall Mount

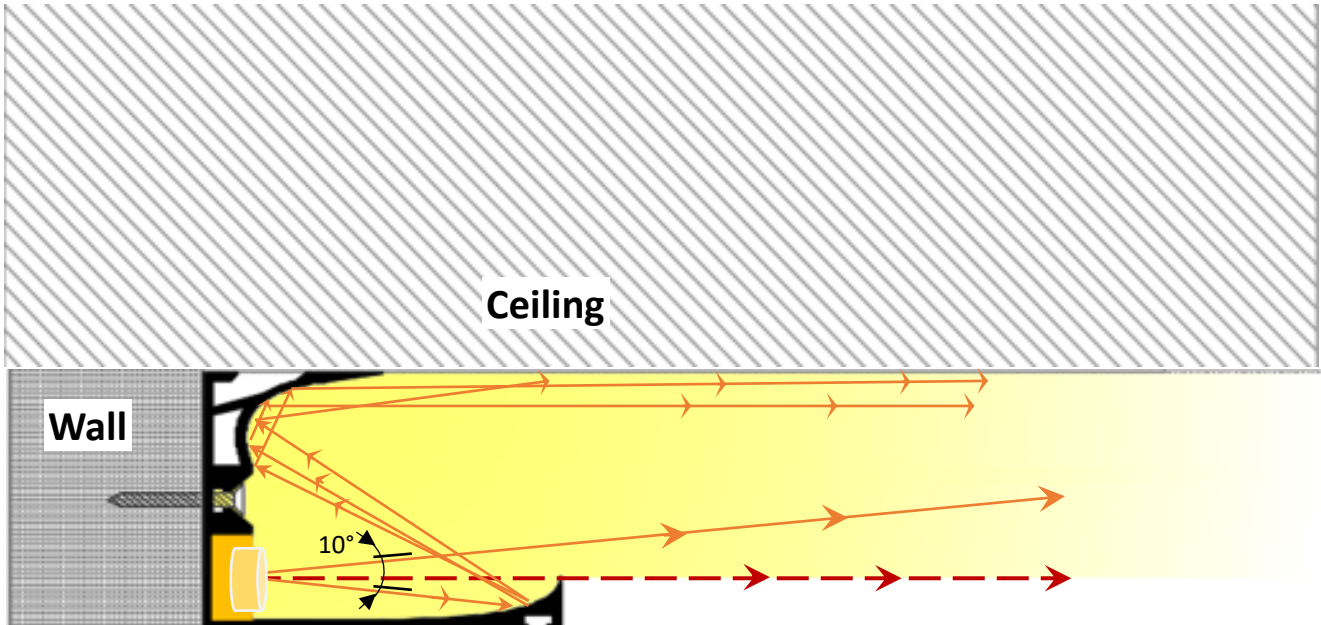

Installation: (G-GO) Ground Grazing / Ground Out

